

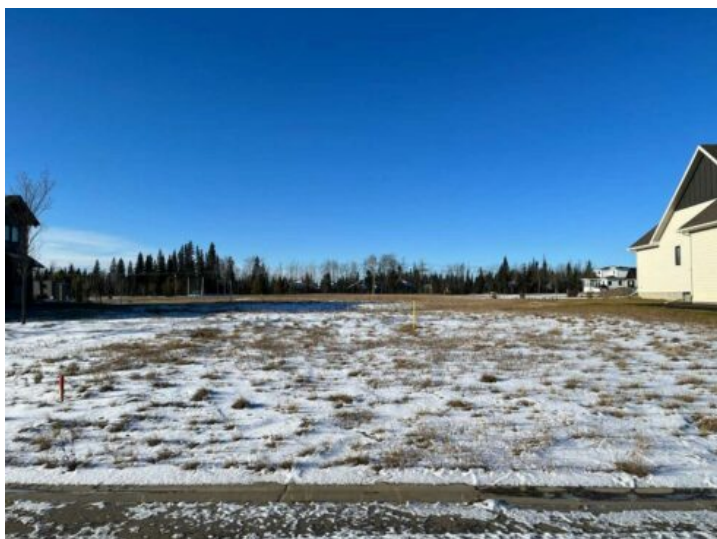

www.keyz.ca  
admin@keyz.ca

5704 Poplar Lane  
Rural Grande Prairie No. 1, County of, Alberta

MLS # A2048924



**\$275,000**

**Division:** Taylor Estates

**Lot Size:** 0.53 Acre

**Lot Feat:** -

**By Town:** Grande Prairie

**LLD:** 8-71-5-W6

**Zoning:** RE

**Water:** Public

**Sewer:** Sewer

**Utilities:** Cable, Electricity, Natural Gas, Phone

Taylor Estates, the most sought after address in the Peace; Taylor Estates affords you all of the convenience of city living and all the comfort of country life in this well-planned community. On the Southwest edge of the city, in the County of Grande Prairie, large rural estate properties are situated on the banks of Bear Creek. Choose your lot, choose your builder, and get started on your Dream Home in Taylor Estates.